



Manual backpack sprayer with 20 litre capacity, with a metal lance integrated in the handle, lever, and metal nozzle. Sprayer suitable for use in extensions exceeding 400 m<sup>2</sup>.

## Advantages

- Chromed brass lance.
- It includes a mixer to ensure the homogeneity in the mixing of the treatment.
- Reinforced leather straps.
- A pressure regulator is included to ensure a homogeneous application.
- Lever fastening to make transportation easier.
- Ambidextrous.
- Lightweight keeping the ergonomics.



## Technical information

| Technical information                                   | SUPER 20  |
|---|---|
| HOSE  | 1.3 m (PVC)   |
| STANDARD NOZZLES  | Metallic adjustable conical   |
| LANCE   | Brass   |
| USEFUL CAPACITY   | 20 L  |
| TOTAL CAPACITY  | 21 L  |
| LITRES/MIN. 1,5 BAR                                     | 0.7l/min  |
| LITRES/MIN. 3 BAR                                       | 1l/min  |
| NET WEIGHT  | 4.42 Kg   |
| WIDE FILLER OPENING                                     | YES   |
| SET OF NOZZLES FOR HERBICIDE AND INSECTICIDE TREATMENTS | YES   |
| STANDARD ACCESSORIES                                    | Pressure regulator, herbicide accessory, two seals (1 rubber and 1 synthetic) and a dispenser |
| LANCE AND EXTENSIONS                                    | Lance/Lever   |
| STRAPS  | Reinforced leather straps   |
| CHAMBER SEAL  | FPM   |
| PRESSURE REGULATOR                                      | YES (3 positions)   |
| HANDLE  | Metallic  |

## Logistics data

| Logistics data           | SUPER 20          |
|--------------------------|-------------------|
| CODE                     | 8.39.45           |
| EAN                      | 84.14685.20020.4  |
| CONDITIONING             | 1 unit            |
| UNITS PER PALLET         | 14 units          |
| DIMENSIONS PER PALLET EU | 1200 X 800 X 1015 |



## Functional information



Pressure regulator (3-position)

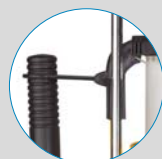

Lance/lever support



Natural concentric chamber with FPM retainer



Brass lance integrated into the lever



Large filling opening



Reinforced straps

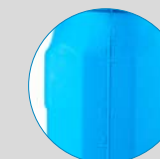

Side sight glass



## ACCESSORIES

Personalize your sprayer adapting it to your application needs (height, hard-to-reach areas...)

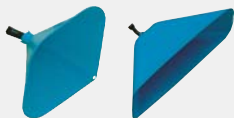

**CONICAL HOOD**  
Reference 8.34.40.870  
**RECTANGULAR HOOD**  
Reference 8.34.40.871



**PRESSURE REGULATOR (SUPER 16 -20 TYPE)**  
Reference 8.34.47.901



**NOZZLE SET**  
Reference 8.34.46.870



**4-HOLE NOZZLE**  
Reference 8.34.46.801



**NORMAL WEED-KILLERS ELBOW**  
Reference 8.34.60.934



**DOUBLE ADJUSTABLE NOZZLE**  
Reference 8.34.46.802

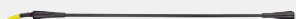

**1 M FIBREGLASS LANCE TUBE WITH COMPLETE ELBOW**  
Reference 8.34.60.873  
**1.5 M FIBREGLASS LANCE TUBE WITH COMPLETE ELBOW**  
Reference 8.34.60.874

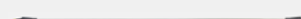

**1 M ALUMINIUM LANCE TUBE WITH COMPLETE ELBOW**  
Reference 8.34.60.871  
**1.5 M ALUMINIUM LANCE TUBE WITH COMPLETE ELBOW**  
Reference 8.34.60.872  
\*Ask for 8.18.75.362 adapter

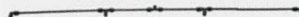

**QUADRUPLE BOOM**  
Reference 8.34.60.870



**FRONT DOUBLE NOZZLE**  
Reference 8.34.60.949



**FLEXIBLE DOUBLE NOZZLE**  
Reference 8.35.40.871



**EXTENDIBLE DOUBLE NOZZLE**  
Reference 8.35.40.872



**3.2 M TELESCOPIC LANCE**  
Reference 8.35.40.913  
**5.4 M TELESCOPIC LANCE**  
Reference 8.35.40.915



**TELESCOPIC EXTENSION**  
Reference 8.35.40.876



**EXTENSION 0.5M**  
Reference 8.35.40.870

## SPARE PARTS

Extend the service life of your sprayer easily replacing parts.

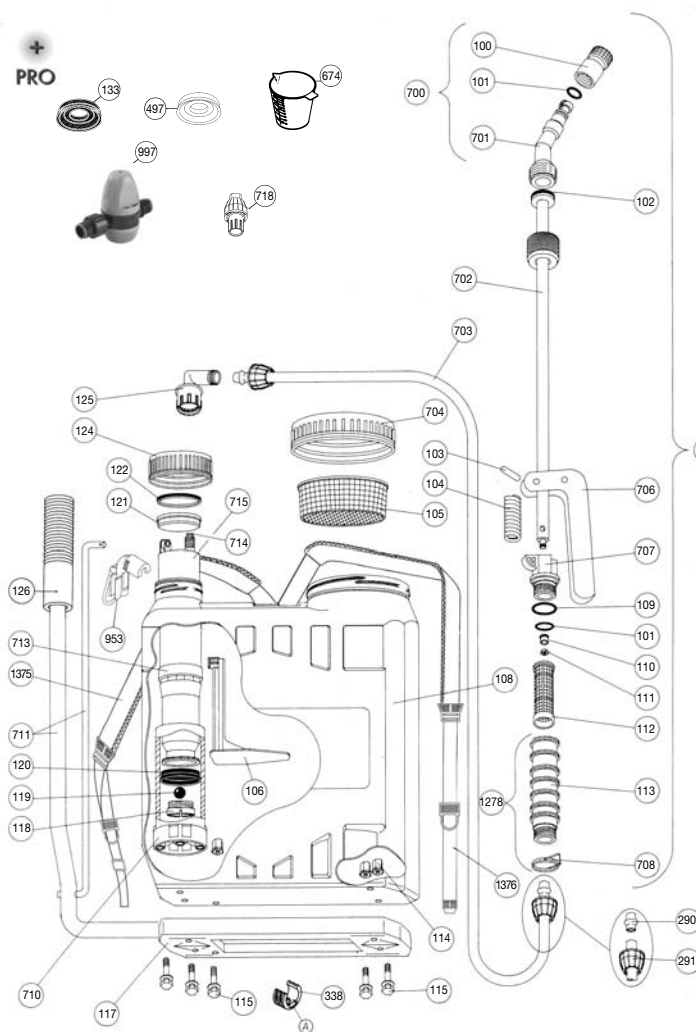

| N.   | COD.      | Q | SPARE PARTS NAME                       |
|------|-----------|---|--|
| 100  | 83905015  | 1 | 1.5 NOZZLE                             |
| 101  | 22315908  | 2 | ROUND GASKET AN-8                      |
| 102  | 84202334  | 1 | FLAT WASHER                            |
| 103  | 83906340  | 2 | LANCE PIN                              |
| 104  | 83909342  | 1 | LANCE SPRING                           |
| 105  | 83918303  | 1 | TANK FILTER                            |
| 106  | 83947306  | 1 | AGITATOR                               |
| 108  | 83945602  | 1 | SUPER-20 TANK                          |
| 109  | 22315916  | 1 | ROUND GASKET AN-16                     |
| 110  | 83906332  | 1 | LANCE GUIDE                            |
| 111  | 26200006  | 1 | M.6 NUT                                |
| 112  | 83808327  | 1 | LANCE FILTER                           |
| 113  | 83928340  | 1 | LANCE GRIP                             |
| 114  | 83928304  | 3 | BASE NUT                               |
| 115  | 25926840  | 5 | 8X40 SCREW AND WASHER                  |
| 117  | 83943302  | 1 | TANK BASE                              |
| 118  | 83909304  | 1 | VALVE                                  |
| 119  | 22008902  | 2 | STAINLESS-STEEL BALL Ø 12              |
| 120  | 83911305  | 1 | VITON SEAL                             |
| 121  | 83911307  | 1 | GUIDE BUSHING                          |
| 122  | 83909409  | 1 | LOCKING WASHER                         |
| 124  | 83911308  | 1 | GUIDE LID                              |
| 125  | 83918322  | 1 | CHAMBER ELBOW                          |
| 126  | 839433041 | 1 | GRIP                                   |
| 133  | 83909306  | 1 | RUBBER SEAL                            |
| 290  | 83808308  | 2 | HOSE BUSHING                           |
| 291  | 84202332  | 2 | NUT                                    |
| 338  | 83943327  | 1 | BASE BUSHING                           |
| 497  | 83941305  | 1 | OPAQUE SYNTHETIC SEAL                  |
| 674  | 83941350  | 1 | 100 ML DOSER                           |
| 700  | 83906811  | 1 | COMPLETE ELBOW                         |
| 701  | 83906663  | 1 | SPRAY ELBOW                            |
| 702  | 83906609  | 1 | LANCE TUBE                             |
| 703  | 83918805  | 1 | COMPLETE HOSE                          |
| 704  | 83947602  | 1 | TANK COVER AND VALVE                   |
| 705  | 83909823  | 1 | COMPLETE LANCE                         |
| 706  | 83906805  | 1 | HANDLE WITH PIN                        |
| 707  | 83811820  | 1 | HANDLE SUPPORT                         |
| 708  | 83918802  | 1 | WASHER WITH HOOK                       |
| 710  | 83947603  | 1 | CYLINDER WITH BALL                     |
| 711  | 83945802  | 1 | COMPLETE LEVER                         |
| 713  | 83943826  | 1 | COMPLETE CHAMBER                       |
| 714  | 83928822  | 1 | PIPE WITH CONNECTOR                    |
| 715  | 83943821  | 1 | PRESSURE CHAMBER AND 714               |
| 718  | 83909883  | 1 | HERBICIDE ACCESSORY                    |
| 953  | 83941811  | 1 | LANCE HOOK                             |
| 997  | 8347901   | 1 | PRESSURE REGULATOR                     |
| 1278 | 83928640  | 1 | COMPLETE FILTER HOLDER                 |
| 1375 | 83943617  | 1 | SUPER ADJUSTABLE STRAP                 |
| 1376 | 83943618  | 1 | SUPER ADJUSTABLE STRAP WITH ATTACHMENT |
|      | 83943200  | 1 | INSTRUCTION SHEET SUPER 20             |
|      | 83945201  | 1 | SUPER-20 PACKAGING                     |