



Manual backpack sprayer with 16 litre - 4.226 gal capacity, with a metal lance integrated in the handle, lever, and metal nozzle. Sprayer suitable for use in extensions exceeding 400 m<sup>2</sup> - 0.098 acres.

## Advantages

- Chromed brass lance.
- It includes a mixer to ensure the homogeneity in the mixing of the treatment.
- Reinforced leather straps.
- A pressure regulator is included to ensure a homogeneous application.
- Lever fastening to make transportation easier.
- Ambidextrous.
- Lightweight keeping the ergonomics.



## Technical information

Technical information	SUPER 16
HOSE	1.3 m - 4.26 feet (PVC)
STANDARD NOZZLES	Metallic adjustable conical
LANCE	Brass
USEFUL CAPACITY	16 L - 4.226 gal
TOTAL CAPACITY	16.8 L - 4.438 gal
LITRES/MIN. 1,5 BAR	0.7 l/min - 0.184 gal/min
LITRES/MIN. 3 BAR	1 l/min - 0.264 gal/min
NET WEIGHT	4.27 kg - 150.62 oz
WIDE FILLER OPENING	YES
SET OF NOZZLES FOR HERBICIDE AND INSECTICIDE TREATMENTS	YES
STANDARD ACCESSORIES	Pressure regulator, herbicide accessory, two seals (1 rubber and 1 synthetic) and a dispenser
LANCE AND EXTENSIONS	Lance/Lever
STRAPS	Reinforced leather straps
CHAMBER SEAL	FPM
PRESSURE REGULATOR	YES (3 positions)
HANDLE	Metallic

## Logistics data

Logistics data	SUPER 16
CODE	8.39.43
EAN	84.14685.20019.8
CONDITIONING	1 unit
UNITS PER PALLET	16 units
DIMENSIONS PER PALLET EU	1200 X 800 X 1020



## Functional information



Pressure regulator (3-position)



Lance/lever support



Natural concentric chamber with FPM retainer



Brass lance integrated into the lever



Large filling opening

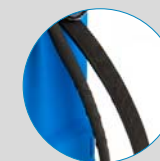

Reinforced straps

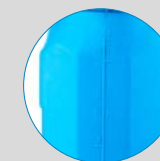

Side sight glass



## ACCESSORIES

Personalize your sprayer adapting it to your application needs (height, hard-to-reach areas...)

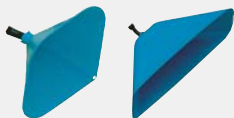

**CONICAL HOOD**  
Reference 8.34.40.870  
**RECTANGULAR HOOD**  
Reference 8.34.40.871



**PRESSURE REGULATOR (SUPER 16 -20 TYPE)**  
Reference 8.34.47.901



**NOZZLE SET**  
Reference 8.34.46.870



**4-HOLE NOZZLE**  
Reference 8.34.46.801



**NORMAL WEED-KILLERS ELBOW**  
Reference 8.34.60.934



**DOUBLE ADJUSTABLE NOZZLE**  
Reference 8.34.46.802



**1 M FIBREGLASS LANCE TUBE WITH COMPLETE ELBOW**  
Reference 8.34.60.873  
**1.5 M FIBREGLASS LANCE TUBE WITH COMPLETE ELBOW**  
Reference 8.34.60.874

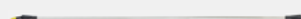

**1 M ALUMINIUM LANCE TUBE WITH COMPLETE ELBOW**  
Reference 8.34.60.871  
**1.5 M ALUMINIUM LANCE TUBE WITH COMPLETE ELBOW**  
Reference 8.34.60.872  
\*Ask for 8.18.75.362 adapter

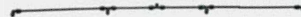

**QUADRUPLE BOOM**  
Reference 8.34.60.870



**FRONT DOUBLE NOZZLE**  
Reference 8.34.60.949



**FLEXIBLE DOUBLE NOZZLE**  
Reference 8.35.40.871



**EXTENDIBLE DOUBLE NOZZLE**  
Reference 8.35.40.872



**3.2 M TELESCOPIC LANCE**  
Reference 8.35.40.913  
**5.4 M TELESCOPIC LANCE**  
Reference 8.35.40.915



**TELESCOPIC EXTENSION**  
Reference 8.35.40.876



**EXTENSION 0.5M**  
Reference 8.35.40.870

## SPARE PARTS

Extend the service life of your sprayer easily replacing parts.

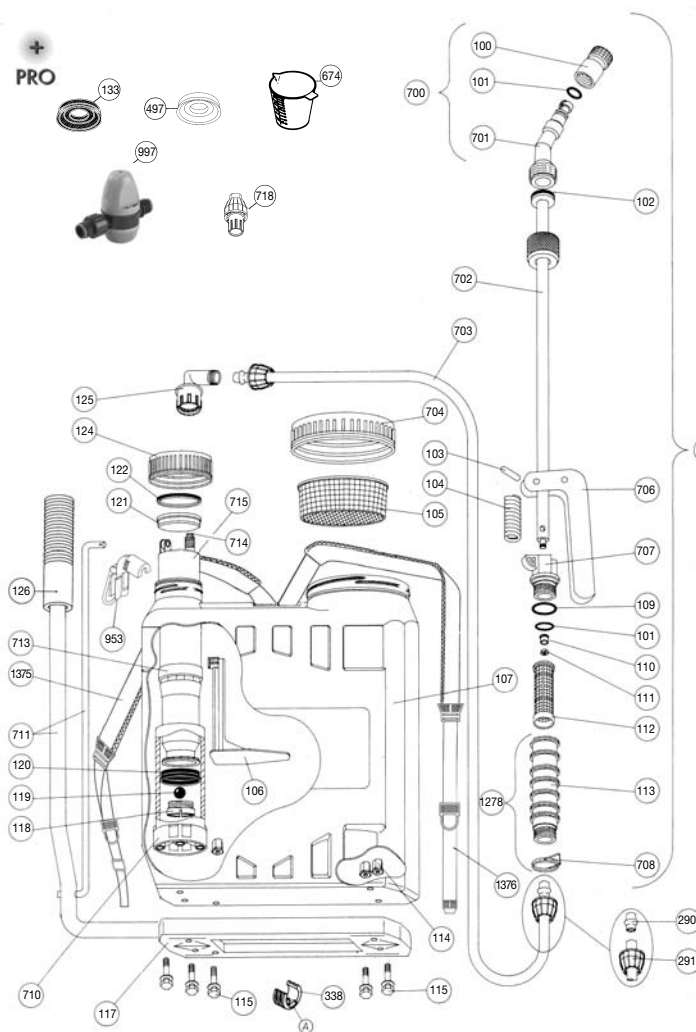

N.	COD.	Q	SPARE PARTS NAME
100	83905015	1	1.5 NOZZLE
101	22315908	2	ROUND GASKET AN-8
102	84202334	1	FLAT WASHER
103	83906340	2	LANCE PIN
104	83909342	1	LANCE SPRING
105	83918303	1	TANK FILTER
106	83947306	1	AGITATOR
107	83943602	1	SUPER-16 TANK
109	22315916	1	ROUND GASKET AN-16
110	83906332	1	LANCE GUIDE
111	26200006	1	M.6 NUT
112	83808327	1	LANCE FILTER
113	83928340	1	LANCE GRIP
114	83928304	3	BASE NUT
115	25926840	5	8X40 SCREW AND WASHER
117	83943302	1	TANK BASE
118	83909304	1	VALVE
119	22008902	2	STAINLESS-STEEL BALL Ø 12
120	83911305	1	VITON SEAL
121	83911307	1	GUIDE BUSHING
122	83909409	1	LOCKING WASHER
124	83911308	1	GUIDE LID
125	83918322	1	CHAMBER ELBOW
126	839433041	1	GRIP
133	83909306	1	RUBBER SEAL
290	83808308	2	HOSE BUSHING
291	84202332	2	NUT
338	83943327	1	BASE BUSHING
497	83941305	1	OPAQUE SYNTHETIC SEAL
674	83941350	1	100 ML DOSER
700	83906811	1	COMPLETE ELBOW
701	83906663	1	SPRAY ELBOW
702	83906609	1	LANCE TUBE
703	83918805	1	COMPLETE HOSE
704	83947602	1	TANK COVER AND VALVE
705	83909823	1	COMPLETE LANCE
706	83906805	1	HANDLE WITH PIN
707	83811820	1	LANCE SUPPORT
708	83918802	1	WASHER WITH HOOK
710	83947603	1	CYLINDER WITH BALL
711	83945802	1	COMPLETE LEVER
713	83943826	1	COMPLETE CHAMBER
714	83928822	1	PIPE WITH CONNECTOR
715	83943821	1	PRESSURE CHAMBER AND 714
718	83909883	1	HERBICIDE ACCESSORY
953	83941811	1	LANCE HOOK
997	8347901	1	PRESSURE REGULATOR
1278	83928640	1	COMPLETE FILTER HOLDER
1375	83943617	1	SUPER ADJUSTABLE STRAP
1376	83943618	1	SUPER ADJUSTABLE STRAP WITH ATTACHMENT
	83943200	1	INSTRUCTION SHEET SUPER 16
	83943201	1	SUPER-16 PACKAGING